

LOT 123
STAGE ONE



MILLFIELD RISE
HUNTER VALLEY



landen

MILLFIELD RISE

HUNTER VALLEY

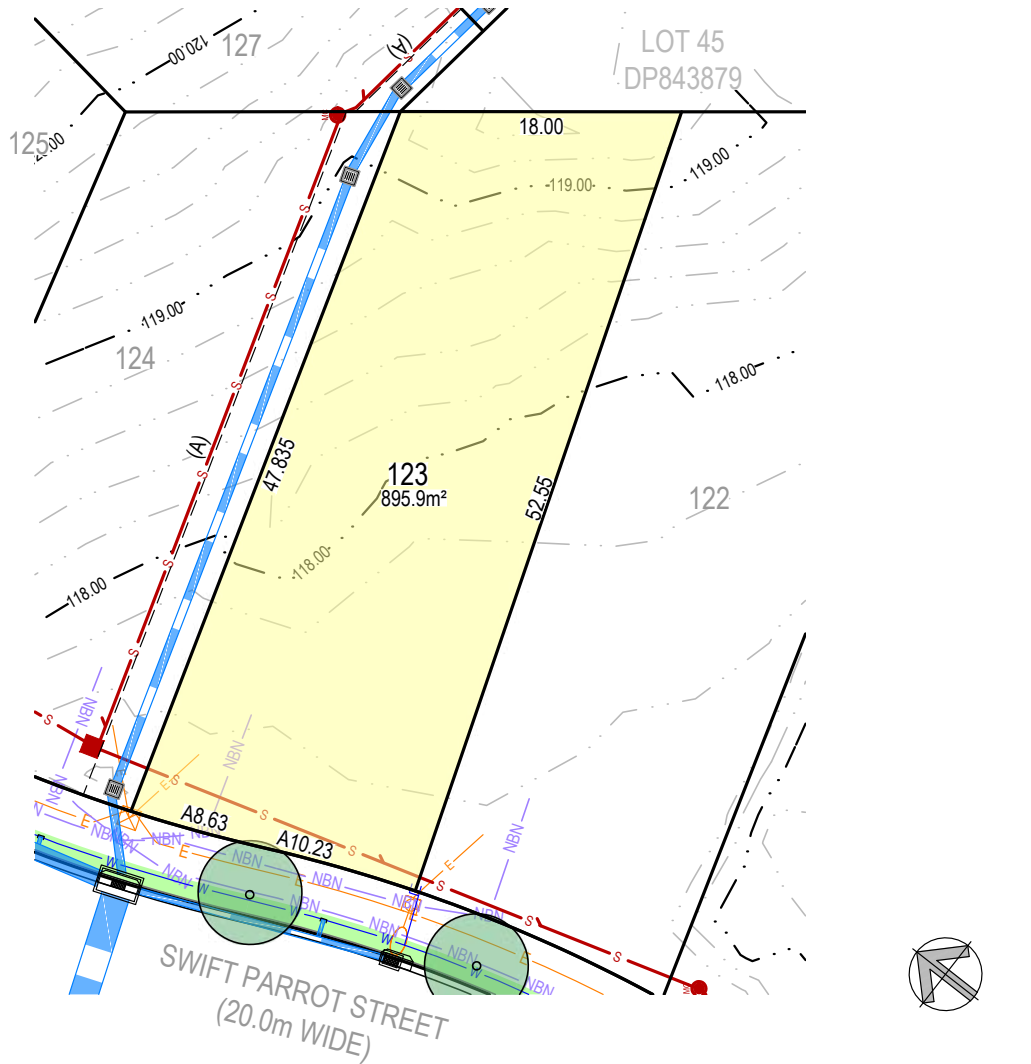

LEGEND

- LOT BOUNDARY
- MAJOR DESIGN CONTOUR
- MINOR DESIGN CONTOUR
- LOT
- FOOTPATH / SHARED PATH
- VERGE
- REQUIRED DRIVEWAY SIDE (BY OWNER)
- KERB RAMP
- STORMWATER PITS
- COUNCIL STREET TREE
- EASEMENT TO DRAIN WATER (1.25m, 2.0m, 2.50m, 3.0m WIDE)
- EASEMENT TO DRAIN WATER (VARIABLE WIDTH)

- EASEMENT TO DRAIN WATER (2.0m WIDE)
- EASEMENT TO DRAIN WATER (2.0m WIDE)
- EASEMENT FOR PUBLIC ACCESS (VARIABLE WIDTH)
- EASEMENT FOR ELECTRICITY & OTHER PURPOSES (3.3m WIDE)
- POSITIVE COVENANT
- BENEFITS FROM EASEMENT (A)
- BENEFITS FROM EASEMENT (D)
- STORMWATER PIPE
- STORMWATER KERB OUTLET
- RETICULATION ELECTRICAL
- RETICULATION TELECOMMUNICATIONS
- RETICULATION WATER
- RETICULATION SEWER
- INDICATIVE FUTURE SEWER

- STREET/LIGHT POLE (2.0m WIDE)
- LV PILLAR / LV LINK PILLAR
- STREET LIGHT
- ELECTRICAL PADMOUNT SUBSTATION
- TELECOMMUNICATIONS PIT
- POTABLE WATER HYDRANT / STOP VALVE
- SEWER MAINTENANCE SHAFT / CHAMBER
- SEWER MAINTENANCE HOLE
- STORMWATER HEADWALL
- STORMWATER PIPE END CAP



NOTE:

1. ALL SERVICES SHOWN ARE INDICATIVE AND SHOULD BE LOCATED PRIOR TO COMMENCEMENT OF ANY WORK

LOT 123
STAGE ONE

Contact Us MillfieldRise.com.au | 1300 103 876

The information contained in this document is for marketing purposes only and does not form part of the contract of sale. Although all efforts have been made to ensure that the information provided is accurate and in accordance with the provisions of the contract of sale, changes may be made during construction and dimensions, areas, and specifications are subject to change without notice. Any aspects, views and perspectives disclosed in this brochure are indicative only. Landen reserves the right to alter designs and specifications without notice at any time. All graphics depicting landscaping and shared and public spaces are indicative only. All interested parties are directed to rely on their own enquiries and consult with their professional adviser in relation to the terms and materials which are included in the contract of sale. All reasonable care has been taken in the preparation of this brochure, but the vendor and its appointed agents disclaim all liability should any information conveyed by or contained within differ from the contract of sale or the actual constructed development.